



Securing Healthcare Institutions

The best in health care and medical research deserves the best in security and **ievo** Ltd's products boast many desirable features for the sector. With solutions designed for busy environments with highly secure or safety conscious areas, **ievo** can be relied upon to operate around the clock.

SECURING YOUR ENVIRONMENT

Health care and medical research institutions are unique, from one facility to another, they all operate in different ways. From busy hospitals to private practices and research facilities, they all function independently but with one common requirement; security. Within each of these facilities a common goal is to protect patients, employees and the valuable assets they use and work with along with access to the building itself. **ievo** solutions integrate with the access control infrastructure to help protect patient records, drugs, medical equipment and can assist in monitoring who has access to specific areas. **ievo** help to obtain clean and contamination free environments by only granted access to these with the required permissions.

DEPENDABLE RELIABILITY

Access levels are an incredibly important way of monitoring staff within a secured premises. Firstly, the term 'access level' refers to allowing certain people access in one or multiple areas of the site, depending on which doors are secured. Configurable within your access control system it is possible to mix and match access levels which is communicated to an **ievo** system.

For example, if you have two **ievo** fingerprint readers on site, one securing your main entry door and the other on a pharmaceutical storeroom, you can restrict users from gaining entry to the storeroom, while allowing everyone access to the main door. This is all done within the same software, offering you complete ease of use.

In addition, if you were to employ time and attendance functions, if an incident did occur on site i.e. theft or vandalism, you would be able to check the access control unit logs. This would highlight exactly who scanned in, at what time and for how long using the scan in/out data logs. This gives you maximum authority over your premises and the contents within.

COST SAVING

An **ievo** integrated biometric access control system can help to reduce costs to your security infrastructure; simple installations means less on-site time for engineers, the modular design of **ievo** systems makes for easy maintenance, integrated systems makes for more practical and functional solutions. The use of time and attendance integration can aid HR, health and safety records and other building services. There are also no costs for producing cards or fobs, or having to replacing lost, stolen or damaged cards/fobs.

BESPOKE SOLUTIONS: IEVO PRODUCTS

The flexibility of **ievo** products means that any site, whether big or small, can be securely protected. From a single door with access control, to a site with multiple doors, car park barriers and rotating doors/ turnstiles; or a small clinic with a low number of employees to a large workforce, the **ievo** range can be tailored to your requirements.

ievo readers are designed to work for you, without you having to restrict or change your security requirements.

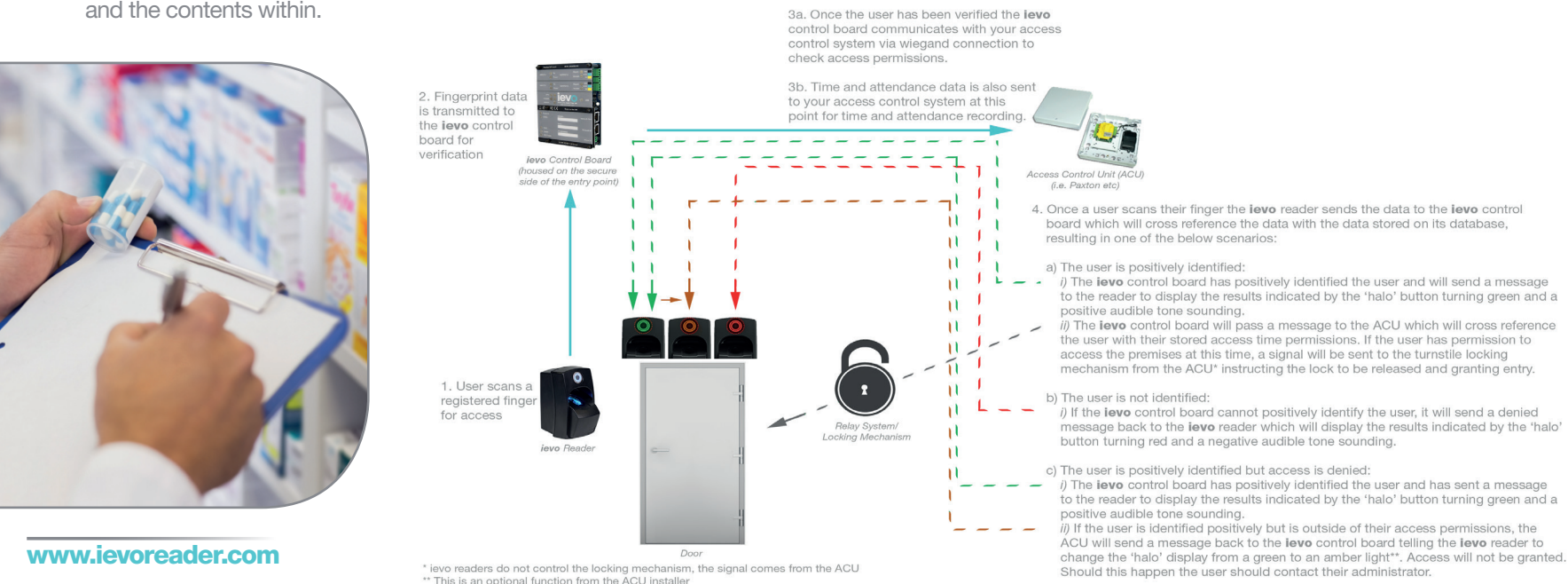

* Ievo readers do not control the locking mechanism, the signal comes from the ACU
** This is an optional function from the ACU installer



RELIABLE. BIOMETRIC. SOLUTIONS.

KEY BENEFITS OF IEVO SYSTEMS

- Additional layer of security for your premises and assets
- Accurate data capture for attendance records
- Cost effective
- No reoccurring costs for replacement cards or fobs
- Improved health and safety records
- Safe and secure environment for your staff and patients
- Integrated system to work with your infrastructure
- Software integration opportunities available
- Future proof design - for any future upgrading or additional development of your security system
- Full customisable and serviceable up to and after the point of sale

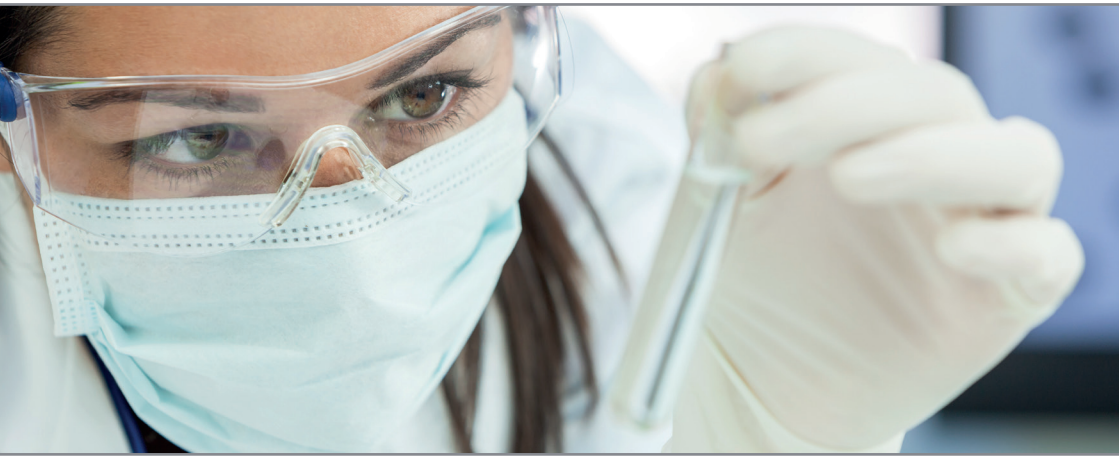

ievo Ltd is a leading design and manufacturer of biometric fingerprint readers. Working with a number of installers and integrators, **ievo** Ltd have a proven international track record securing healthcare facilities.

For case studies or further information, please contact our support team:

info@ievoreader.com

Tel: 0845 643 6632 / +44 (0) 191 296 3623

or visit:

www.ievoreader.com