



Security solutions
as individual as you are.™

A low-angle, upward-looking photograph of several modern skyscrapers with glass facades, reaching towards a blue sky with scattered white clouds. The perspective creates a sense of height and architectural grandeur.

Securing Commercial Properties

Commercial properties drive demand for high quality and proven solutions when it comes to satisfying prerequisite of tenants in terms of security measures. Reliability, accuracy and simplicity are key components to delivering the standards expected by property managers and investors to ensure the safety of their tenants, with **ievo** Ltd solutions you get robust, innovative and practical solutions to suit the needs of the property and tenants.

SECURING YOUR PROPERTY

At **ievo** we understand that building management is not always an easy task, with a multitude of requirements and tenant requests. We try and keep things simple without any sacrifices to quality.

The **ievo** fingerprint reader range offers a comprehensive biometric layer of security to your access control infrastructure. Integration with a wide range of well-known access control systems, such as; Paxton, Stanley, Honeywell and Nortech, allow for a smarter and seamless level of integration between systems. The integration opportunities between systems provides reduced installation, set up and training time and is therefore cost effective, without necessarily having to replace systems, **ievo** products can be synchronised within an existing system to help safeguard your tenants.

With adaptable modifications, **ievo** solutions can be upgraded to meet the scale of operation as your needs and tenant's requirements grow. The user friendly devices are simple, effective and accurate, covering the systematic needs of a diverse portfolio of tenants.

SOLVING PROBLEMS FOR MULTI-USE PROPERTIES

There are many benefits to employing an **ievo** integrated biometric solution, besides the robust and reliable nature of the products they can be used to combat any number of issues. An **ievo** system can be configured within your access control system to be partitioned, allowing for different access rights for different users, which can be beneficial within a shared commercial building with communal entry points. After a quick and secure registration process you can have tenants set up with the require access rights to the main building, and or their own internal building space.

ievo systems can support multiple card types along with its biometric solution. If you have tenants that wish to use an existing card scheme, this can be integrated into the **ievo** system via the optional upgrade of a card reader module*. This option turns the **ievo** reader into a dual system, which can function with biometric fingerprint readings, and card systems.

If you find that a building requires a larger user capacity that the standard 10,000 user template, this can be upgraded to a capacity of 50,000 user templates, allow you to grown with your tenants requirements.

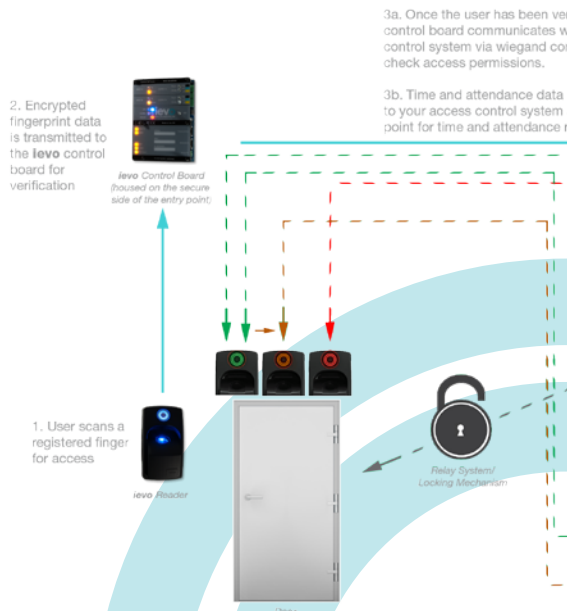

DEPENDABLE, RELIABLE AND ACCURATE

Within commercial building it can often be hard to monitor exactly what is going on and who is who. Keeping up with a tenant's internal recruitment regimes can be an impossible task for building managers. By utilising a biometric management system, you have a supply of accurate and reliable records that can be configured with your access control system for fire and health & safety, or attendance records. The benefits to your tenants, apart from an increase of safety measures is that HR departments can be provided with reliable data for payroll and avoiding any employee disputes; improving general management of large workforces.

COST SAVING

The benefits of a biometrically lead access control system over common card/fob reader systems, is that there are no continuous replacement costs. Systems relying on secondary credentials to allow access (i.e. physical cards/fobs etc), are vulnerable to the credentials being lost, stolen or shared. Stolen or lost credentials leave your security measures exposed to whomever holds the key, additionally there is a cost to replace this for the user. With biometrics this issue is erased. Using **ievo** systems the only persons permitted entry are those registered on the system, when registering this data cannot be used or manipulated for any other purpose.

You have the peace of mind that only your tenants will have access to the building, and this peace of mind can be passed directly to them, so they know that they and their assets are securely protected.

INTERNAL & EXTERNAL SOLUTIONS

The **ievo** product range offers solutions for both internal and external requirements. The **ievo ultimate™** is our flagship fingerprint reader, designed as a fully functional biometric reader, it withstands use in harsh external environments (i.e. heavy rain, to up -20° temperatures, and areas with a high volume of footfall), and is ideal for commercial property use. Being highly accurate and reliable due to the internal scanning systems of the device, we are confident that the *ultimate* will meet the requirements of you and your tenants. The **ievo micro™** is our internal only device, designed for use within 'clean' environments, it offers the same reliability and accuracy of the *ultimate*, but is specifically designed to cater for those wanting an internal only solution for a smaller volume of users.

ified the **ievo**
with your access
connection to



4. Once a user scans their finger the **ievo** reader sends the data to the **ievo** control board which will cross reference the data with the data stored on its database, resulting in one of the below scenarios:

- a) The user is positively identified:
 - i) The **ievo** control board has positively identified the user and will send a message to the reader to display the results indicated by the 'halo' button turning green and positive audible tone sounding.
 - ii) The **ievo** control board will pass a message to the ACU which will cross reference the user with their stored access time permissions. If the user has permission to access the premises at this time, a signal will be sent to the turnstile locking mechanism from the ACU* instructing the lock to be released and granting entry.
- b) The user is not identified:
 - i) If the **ievo** control board cannot positively identify the user, it will send a denied message back to the **ievo** reader which will display the results indicated by the 'halo' button turning red and a negative audible tone sounding.
- c) The user is positively identified but access is denied:
 - i) The **ievo** control board has positively identified the user and has sent a message to the reader to display the results indicated by the 'halo' button turning green and positive audible tone sounding.
 - ii) If the user is identified positively but is outside of their access permissions, the ACU will send a message back to the **ievo** control board telling the **ievo** reader to change the 'halo' display from a green to an amber light**. Access will not be granted. Should this happen the user should contact their administrator.



KEY BENEFITS OF IEVO SYSTEMS

- Safe and secure environment for your tenants
- Improved fire and health & safety records
- Additional layer of security for your property
- Cost effective
- Saves money, increases revenue and profits passed directly to your tenants
- Integrated system to work with your infrastructure
- Software integration opportunities available
- Future proof design - for any future upgrading or additional development of your security system
- Full customisable and serviceable up to and after the point of sale
- Customisable colours to discreetly blend into your, and your tenants, environments.



ievo Ltd is a leading design and manufacturer of biometric fingerprint readers. Working with installers and integrators, **ievo** Ltd have a proven track record of securing commercial properties worldwide.

For case studies or further information, please contact our support team:

info@ievoreader.com

Tel: 0845 643 6632 / +44 (0) 191 296 3623

or visit:

www.ievoreader.com